

**153,748 stars to sleep with.**

TO ALL WHO ARE CURIOUS  
ABOUT THE UNIVERSE



# pococo

LIKE GALAXY BE YOURSELF



**A GUIDE  
TO SPACE  
EXPLORATION**

**List of Items**

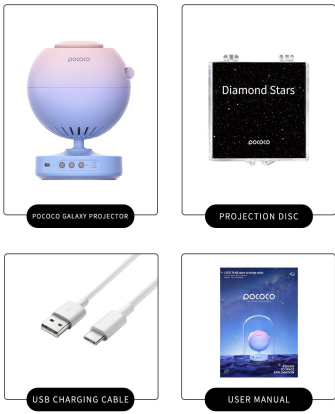

**Product Description**

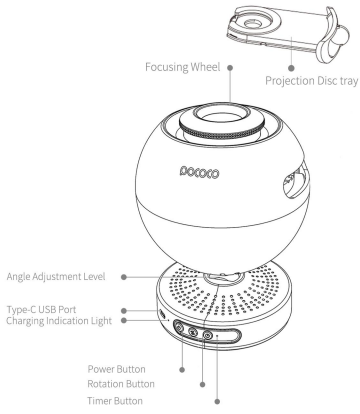

**Button Functions**

- (1) Power Button:** Press the power button to turn on the projector and enjoy this healing and relieving visual feast. Press the power button again to shut off all power consumption functions.
- (2) Rotation Button:** Press the rotation button to turn on the rotation function. Press the button again to stop the rotation.
- (3) Timer Button:** Press the timer button once to turn on the timer function. The timer is set to be 15 min. The timer indicator flashes very slowly. Press the button the second time to set the timer to 30 min. The timer indicator flashes slowly. Press the button the third time to set the timer to 1 hr. The timer indicator is always on. Press the button the fourth time to cancel the timer. The timer indicator is off.

All the power consumption functions will be shut off once the timer stops.



**Cautions**

- Children need adult's supervision to use.
- Please use the proper power adaptor (Nominal 5V)
- This product should be used and stored under normal temperature and humidity to extend its service life. The projection lens is an optical element. Please DO NOT use your hands to directly touch the lens or wipe off its surface. Small dusts will not affect its projection performance.
- Please keep this product away from any heat source, moisture, and any other harsh environments.
- Please DO NOT disassemble or modify this product by any means.
- Please DO NOT use this product if it is damaged or faulty.
- Please DO NOT stare directly into the light source.
- Contains small parts. Please DO NOT swallow.
- Contains Lithium Battery. Please keep away from direct sunlight heat, or similar environments.

**How to Use**

**1 Please Check Before Use**

- I. Whether the projector is damaged.
  - II. Whether the USB charging cable is damaged.
- \*Please stop using this product and contact our service department immediately if any of the above damages are found. (Children under the age of 12 must use this projector under the guidance of an adult.)

**2 Operation Environment**

- Use this projector in an indoor dark environment.
- Please avoid ambient lighting that may affect the performance of the projector.
- To maximize your user experience, please use a wide-open and flat white wall or screen as the projection plane.

**2 Two Power Supply Methods**

- I. Use the USB charging cable to connect the projector to the 5V power adapter.
- The power adapter can supply power to the projector and charging the projector at the same time.

- Charging. The charging indication red light is always on.
- Fully charged. The charging indication green light is always on.

- II. Without USB charging cable connected to the projector, the project can be powered by the built-in Lithium Battery. The charging indicator will flash red when the battery is running low.

**3 Operation Guide**

**(1) Projection Disc Installation**

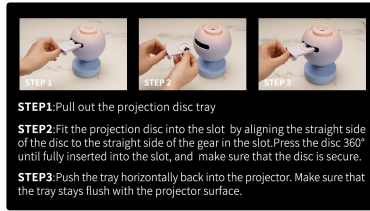

**(2) Projection Angle Adjustment**

Manually adjust the lever to change projection angle as needed. The adjustable angle range is  $\pm 30^\circ$ .



**(3) Focusing:**

This product has a focusing function. The focusing wheel with the red arrow marks can be rotated clockwise and counterclockwise. Please rotate the wheel clockwise all the way until you cannot turn it anymore with minimum force. Next, rotate the wheel counterclockwise and watch the projection until the image is in focus. Note: Due to factors such as projection angle, the edge of the projected image may occur to be blurry while the center of the image is clear. This is completely normal.



**FAQ**

**Q: Why the projected images are partially blurry sometimes?**

**A:** The edge of the images may occur to be blurry due to projection angles. It is acceptable that 80% of the image area is in focus.

**Q: The entire projection image is blurry during use. How can I improve this?**

- A:**
1. Check whether the projection disc is properly installed in the slot. PS: Press the disc 360°, make sure it fully inserted into the slot.
  2. Check if the focus is properly adjusted.
  3. Check whether the lens protection film has been removed.
  4. Try install the projection disc upside-down or use a different disc. If the issues are still not resolved, please contact customer service.

**Q: Why the rotation is slow? Is it due to something I did during the installation?**

**A:** Each person has their own preference as to the rotation speed. We have conducted many tests to find the rotation speed that accommodates the comfort and experience of most users. Hope that it will give you the best experience as well.

**Q: Sometimes the rotation lags and jams/makes weird noises. What is the cause of this?**

- A:**
1. The battery is low.
  2. Check whether the tray is inserted fully in the projector. You can check this by running your fingers through the ray surface to see if the tray stays flush with the projector.
  3. Check whether the projection disc is aligned correctly in the slot.

**Q: My projection disc fell into the projector. How can I get it out?**

**A:** Take out the disc tray, tilt the projector so that the slot opening is pointing downwards. Shake the projector until the disc falls out of the projector.

**Q: The focusing wheel is too tight to rotate but the image is still not in focus. What should I do?**

- A:**
1. If the lens is in its upper-most position, rotate the wheel clockwise to loosen the wheel.
  2. If the lens is in its lower-most position, rotate the wheel counterclockwise to loosen the wheel.

**FOUR PROJECTION DISC SERIES**

**GORGEOUS NEBULA**

A nebula is a distinct body of interstellar clouds. Originally, the term was used to describe any diffused astronomical object, including galaxies beyond the Milky Way. The Andromeda Galaxy, for instance, was once referred to as the Andromeda Nebula before the true nature of galaxies was confirmed in the early 20th century by Vesto Slipher, Edwin Hubble and others.



**ZODIAC SERIES**

There are 12 zodiacs in the zodiac family. They can all be seen along the ecliptic. They are: Aries, Taurus, Gemini, Cancer, Leo, Virgo, Libra, Scorpio, Sagittarius, Capricornus, Aquarius and Pisces.

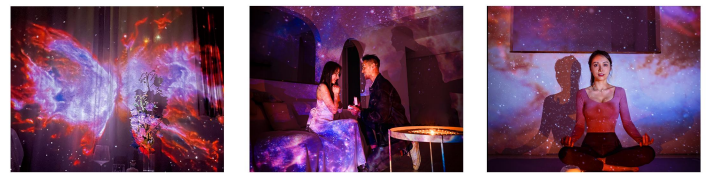

**SOLAR SYSTEM**

The Solar System is the gravitationally bound system of the Sun and the objects that orbit it, in the space that we call the Solar System. The largest are the four gas giant planets and the four terrestrial planets, followed by an enormous number of dwarf planets and interstellar and Solar System bodies.

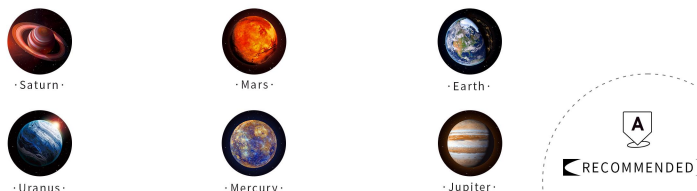
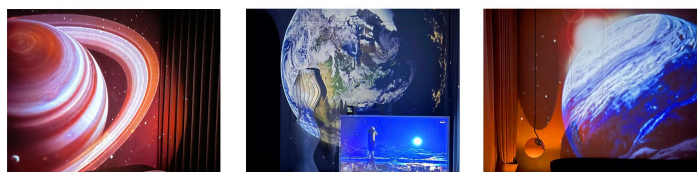

**AURORA DEEP-SEA**

An aurora, also known as the polar lights or aurora borealis, is a natural light display in Earth's sky, predominantly seen in high-latitude regions. Auroral displays appear as patterns of bright lights that appear as curtains, rays, spirals, or dynamic ribbons covering the entire sky.

