



# User Manual

Model: H7025

Govee Outdoor Clear Bulb String Lights

# INSTALLATION OR ASSEMBLY INSTRUCTIONS

## READ AND FOLLOW ALL SAFETY INSTRUCTIONS.

When using products, basic precautions should always be practiced including the following:

- This String Light is rated as IP67 Waterproof.
- Risk of Electric Shock. The adapter install only to a covered Class A GFCI receptacle that has an enclosure that is weatherproof with the attachment plug cap inserted or removed.
- Tighten up the waterproof cap before installing the light.
- The light source of this luminaire is not replaceable; when the light source reaches its end of life the whole luminaire shall be replaced.
- Do not allow children to assemble and install this product without adult supervision.
- Avoid installing this product near major heat sources.
- External dimmers cannot be used with this product.
- Use this product with the provided power adapter only.
- Any open ends must be sealed-off before use.
- To reduce the risk of strangulation, the flexible wiring connected to this luminaire shall be effectively fixed to the wall if the wiring is within arm's reach.
- Do not connect the chain to the supply while it is in the packaging.
- Do not remove or insert lamps while the chain is connected to the supply.
- Do not open or cut the light.
- This product includes a built-in mic that can recognize sound information to synchronize lights and music.
- CAUTION -The product is not a toy. Children and the disabled should use it under adult supervision.

## SAVE THESE INSTRUCTIONS

# Introduction

Thanks for choosing the Govee Outdoor Clear Bulb String Lights. This product has an IP67 waterproof rating, making them ideal for outdoor use. Using Govee Home App, you can adjust its color and brightness and sync its lighting effects with rhythm by turning on Music Mode.

## What You Get

Item	Quantity
String Light	1
Adapter	1
Control Box	1
User Manual	1

## At a Glance

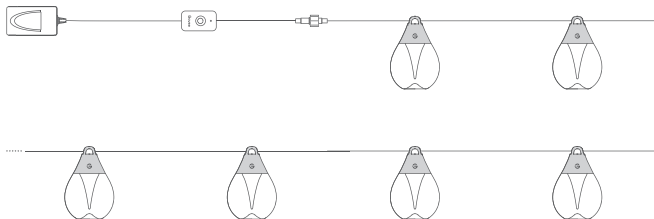

- Press to turn the light on or off.
- Long press for 5 seconds to reset.



## Installing Your Device

1. Connect the cables and firmly tighten the cable caps.

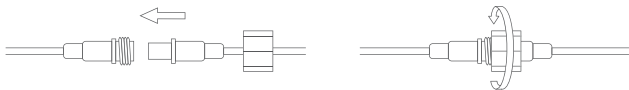

2. Hang the String Light to where you planned. And you may use plastic strips to locate specific points of the String Light.

# Pairing Your Light with Govee Home App

## What You Need

- A Wi-Fi router supporting 2.4GHz and 802.11 b/g/n bands.5GHz is not supported.
- A smartphone or tablet running iOS or Android.



1. Download Govee Home App from the App Store (iOS devices) or GooglePlay (Android devices).
2. Turn on your smartphone's Bluetooth.
3. Open the app, tap the “ + ” icon in the top right corner and search for “H7025”.
4. Tap the device icon and follow the on-screen instructions to complete pairing.

## Matter Guide

### Cautions:

1. You need to complete the network connection of apps that support Matter (eg.Google Home/Apple Homekit etc.) within 15 minutes after the product is powered on when using Matter for the first time.
2. An IPv6 network is required.
3. Changing the network may cause Matter to malfunction.
4. If the product cannot connect to the app, press and hold the power button on the control box for 5 seconds to restore the factory settings. After that, try connecting again later.

### Step 1

Find the QR code or device number of Matter on the product or on Device Settings page in Govee Home App.

### Step 2

Turn on the Bluetooth on your smartphone.

### Step 3

Download and open the app that supports Matter like Google Home/Apple Homekit, etc.

### Step 4

Use the device number or QR code on the product in the app to complete the network connection of Matter for the product.

## Specifications

Power Input	100-240VAC 50/60Hz
Power Output	24VDC 1A
Total Length (Including control box and power adapter)	48ft / 14.63m
Light Color	RGBW
Waterproof	String Light (IP67) Control Box (IP65)
Working Temperature	-20°C ~ 40°C / -4°F ~ 104°F

# Troubleshooting

1. Failed to connect to Govee Home App.
    - a. Make sure the string lights are connected to power.
    - b. Make sure your smartphone's Bluetooth is enabled.
    - c. Keep your smart phone close to the control box and try again.
  2. Missing parts/Receiving products from a secondary sale.
    - a. Check the pictures on the web page to confirm what parts are missing and contact customer service in the app for replacements.
    - b. If you received a product from a secondary sale or a product that cannot work properly, please contact customer service in the app for a replacement.
  3. Network failure.
    - a. Make sure your home Wi-Fi is 2.4 Ghz, and your smartphone's Bluetooth is on.
    - b. Long press the control box for more than 5s to reset the whole light. Unbind and then rebind the light.
    - c. If the light is too far away from the Wi-Fi, bring the device closer to the Wi-Fi, and then reconnect to the network.
    - d. Check if there are too many devices connected to the network. If so, change to another network.
    - e. If the above methods cannot solve your problems, please contact customer service in the app to replace the control box.
  4. App operation guide is needed.
    - a. Open Govee Home App, tap My Profile>>Govee Instructions>>AppGuide>>How to Use, to find more details.
- If your problem persists, please contact Customer Support.

# Customer Service

 Warranty: 12-Month Limited Warranty

 Support: Lifetime Technical Support

 Email: [support@govee.com](mailto:support@govee.com)

 Official Website: [www.govee.com](http://www.govee.com)

 @GOVEE    @goveeofficial    @govee.official

 @GoveeOfficial    @GOVEE

# FCC and ISED Canada Statement

This device complies with Part 15 of the FCC Rules and Innovation, Science and Economic Development Canada licence-exempt RSS standard(s). Operation is subject to the following two conditions: (1) This device may not cause harmful interference, and (2) This device must accept any interference received, including interference that may cause undesired operation.

**Warning:** Changes or modifications not expressly approved by the party responsible for compliance could void the user's authority to operate the equipment.

**NOTE:** This equipment has been tested and found to comply with the limits for a Class B digital device, pursuant to Part 15 of the FCC Rules.

These limits are designed to provide reasonable protection against harmful interference in a residential installation. This equipment generates uses and can radiate radio frequency energy and, if not installed and used in accordance with the instructions, may cause harmful interference to radio communications. However, there is no guarantee that interference will not occur in a particular installation. If this equipment does cause harmful interference to radio or television reception, which can be determined by turning the equipment off and on, the user is encouraged to try to correct the interference by one or more of the following measures:

1. Reorient or relocate the receiving antenna.
2. Increase the separation between the equipment and receiver.
3. Connect the equipment into an outlet on a circuit different from that to which the receiver is connected.
4. Consult the dealer or an experienced radio/TV technician for help.

This Class B digital apparatus complies with Canadian ICES-005.

# FCC and IC Radiation Exposure Statement

This equipment complies with FCC and IC radiation exposure limits set forth for an uncontrolled environment. This equipment should be installed and operated with minimum distance 20cm between the radiator & your body.

Responsible party (this contact information is only for FCC matters) :

Name: GOVEE MOMENTS(US) TRADING LIMITED

Address: 2501 Chatham Rd Suite R Springfield IL 62704

Email: certification@govee.com

Contact information: <https://www.govee.com/support>

The Bluetooth® word mark and logos are registered trademarks owned by Bluetooth SIG, Inc. and any use of such marks by Shenzhen Qianyan Technology LTD is under license.

The trademark Govee have been authorised to Shenzhen Qianyan Technology LTD.

Copyright ©2021 Shenzhen Qianyan Technology LTD.

All Rights Reserved.



**Govee Home App**

For FAQs and more information,  
please visit: [www.govee.com](http://www.govee.com)